

M/Y SAFARI SPIRIT



American Safari Cruises

Exclusive Yacht AdventuresSM



UNIQUE

*12 berths for private charter
or book-by-stateroom*

RARE

*Upper deck staterooms
with sliding glass doors
and step-out balconies*

EXCLUSIVE

*Two days of hiking and
kayaking in Alaska's Glacier
Bay plus Alaska's foremost
whale-watching in Frederick
Sound and Icy Strait*

ALASKA'S INSIDE PASSAGE
May – September

PACIFIC NORTHWEST RIVERS
September – November

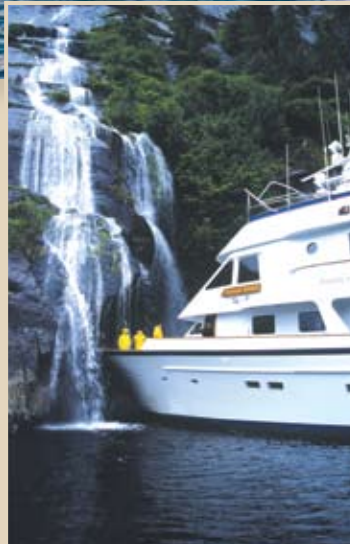

Rudolph Schmidt

The elegantly-appointed M/Y *Safari Spirit* is built for adventurous pursuits. Kayaking excursions, guided hikes and behind-the-scenes included tours give way to total relaxation in the cedar sauna, on-deck hot tub, en suite jacuzzi tubs, over-sized staterooms, observation lounge/library or the spacious main salon.





AMENITIES & ACTIVITIES

- An on-deck hot tub
- Onboard exercise equipment such as elliptical trainer and exercise bike
- A large screen TV/DVD in the salon
- A full-beam swim-step for ease in boarding the four two-person sea kayaks and the high-speed skiff
- Hair dryers, bathrobes, iPod docking station/clock, binoculars and TV/DVD in each stateroom
- Heated tile floors in bathrooms
- Tempur-pedic® memory foam mattresses
- A library highlighting information on cruising destinations as well as fiction and other genres
- Video library containing hundreds of DVD titles
- Fishing in Alaska
- Included bar stocked with premium spirits, fine wines and micro-brews

SAFARI SPIRIT

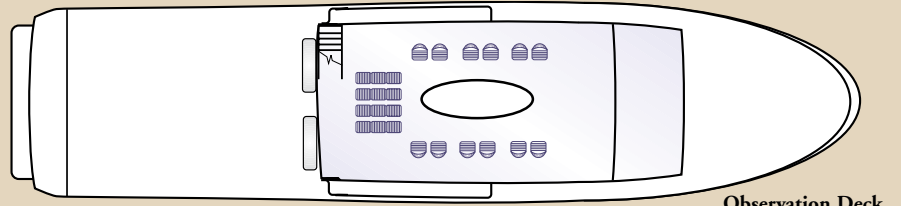

Observation Deck

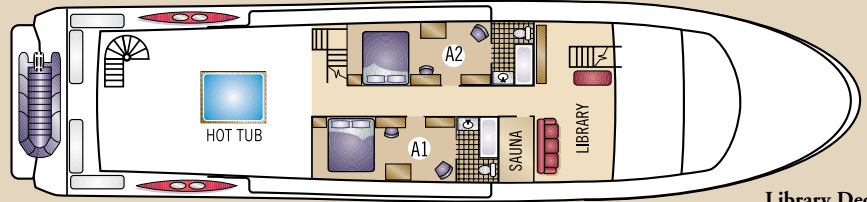

Library Deck

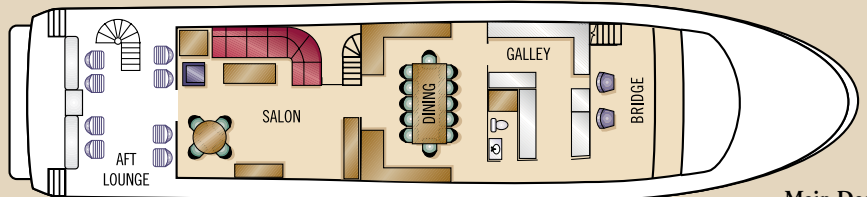

Main Deck

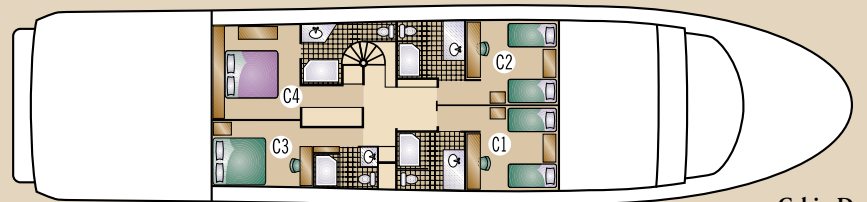

Cabin Deck

| | |
|-----------------------|----------------|
| STATEROOMS | 6 doubles |
| GUEST MAXIMUM | 12 |
| LENGTH | 105 feet |
| BEAM | 24.5 feet |
| DRAFT | 6 feet |
| MAXIMUM HEIGHT | 50 feet |
| CREW | 6 |
| PREVIOUS NAME | Netanya |
| DATE CONSTRUCTED | 1981 |
| DATE REBUILT/REFITTED | June 2005 |
| BUILDER | Poole-Chaffee |
| CRUISING SPEED | 11 knots |
| MAIN ENGINES | Detroit 12V71 |
| AUXILIARY ENGINES | Detroit |
| FUEL TANKAGE | 12,000 gallons |
| WATERMAKER | Yes |
| WATER TANKAGE | 3,500 gallons |
| OFFICIAL NUMBER | 631818 |
| FLAG | U.S. |



Admiral Staterooms A1 and A2

Feature king or twin beds, large sliding glass door opening to a small balcony, and private bath with Jacuzzi tub and shower.



Captain Stateroom C4

Features king bed, opening portholes for viewing, and private bath with Jacuzzi tub and shower.



Commander Staterooms C1, C2 and C3

Feature twin or queen beds, opening portholes for viewing, and private bath with Jacuzzi tub and shower.



At a ratio of one crewmember for every two guests, the full crew includes an Expedition Leader/Naturalist on every cruise.

